

Evans PW SERIES

PCW Regulator



Evans PW Series Stick with Integrated Regulator



EVANS PW SERIES REGULATOR

Table of Dimensions

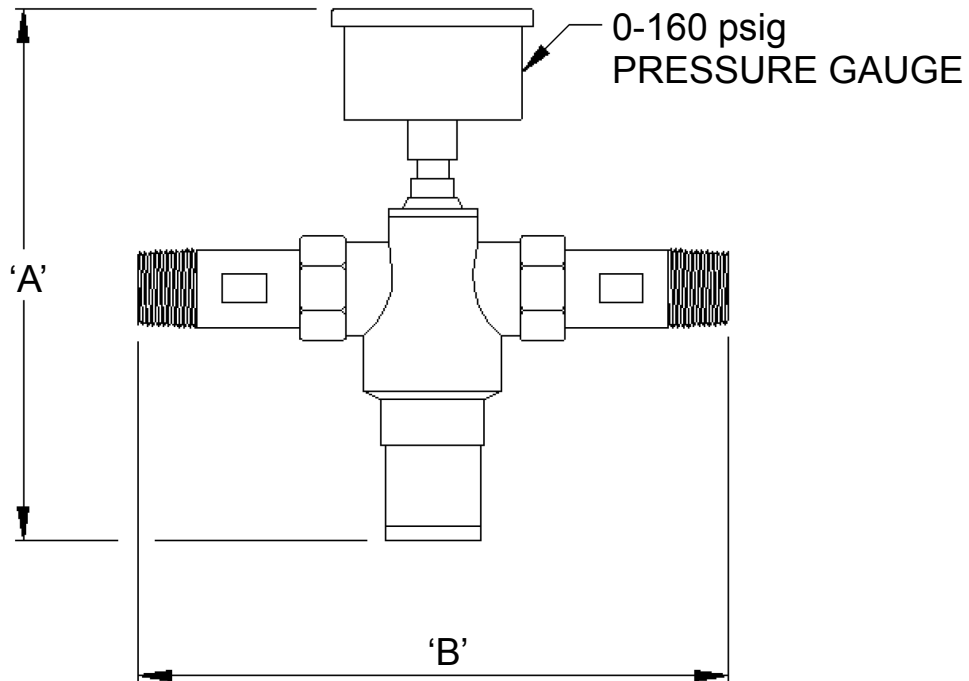

Part Number	Size Inches/mm	Overall Height 'A' Inches/mm	End to End Length 'B' Inches/mm
PW-08-VE*-0470-G160	1/2" 12.7	7.2 182	7.7 196
PW-12-VE*-0570-G160	3/4" 19.05	7.2 182	8.0 203
PW-16-VE*-0670-G160	1" 25.4	8.0 203	9.1 231
PW-20-VE*-0770-G160	1-1/4" 31.75	8.3 211	9.1 231
PW-24-VE*-0870-G160	1-1/2" 38.1	8.5 216	9.0 229
PW-32-VE*-0970-G160	2" 50.8	8.7 221	9.9 252

Dimensions are +/- 0.3"

Optional End Connections (insert designator in * part number)

M - 304 Stainless Male NPT

PM - PVC Male NPT

C - Stainless Compression

EVANS PW SERIES REGULATOR

Technical Specifications

Materials of Construction

Body: Nickel Plated Brass
 Seals: Elastomer Nitrile
 Seat Seal: 303 Stainless
 Stopper: Elastomer Nitrile

Pressure/Temperature Ratings

Fluid: Water
 Inlet Pressure: Max 215 psig (15 bar)
 Minimum Adjustable Outlet Pressure: 10 psig (0.5 bar)
 Maximum Adjustable Outlet Pressure: 100 psig (7 bar)
 Maximum Temperature Rating: 176F (80C)

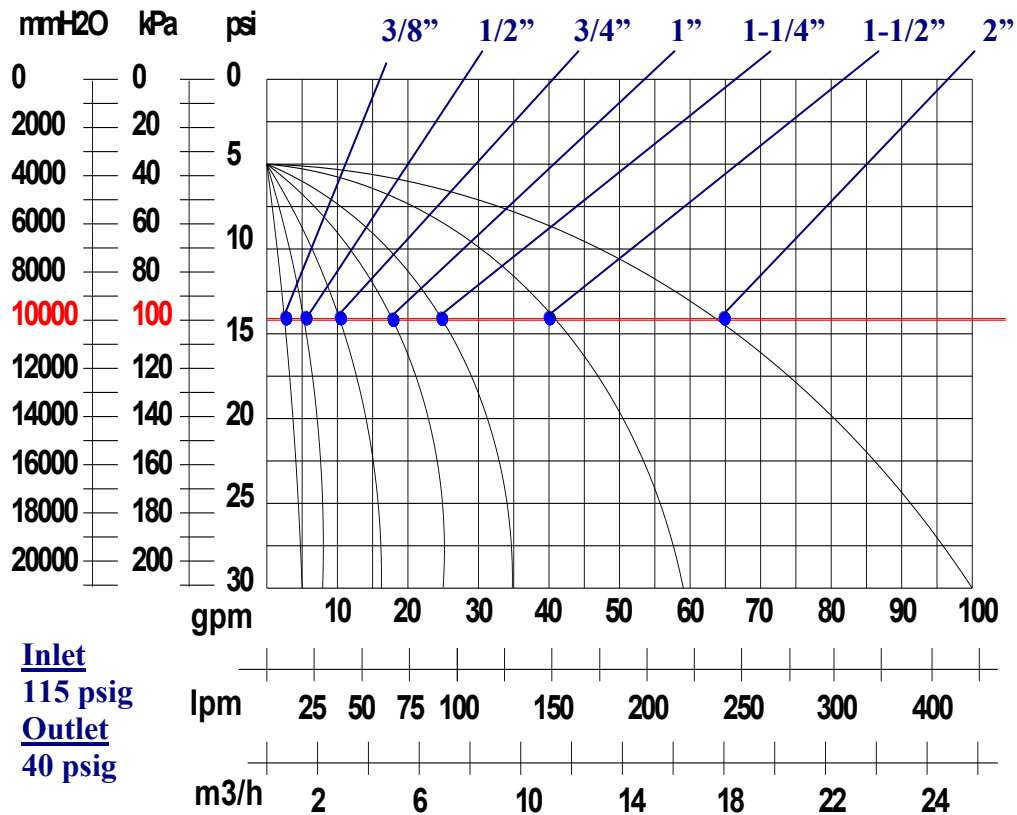

Evans PW Series

PCWS/R Hook-up Sticks



Evans Integrated Pressure / Temperature Gauge
"Bi-Dicator" 0-100psig / 0-140° F

Advantages of Evans Bi-dicator

- Replaces two devices with one
- Lower cost
- Fewer potential leak points
- Reduce overall footprint for tool hook-up
- Stainless case and stem



Evans Components, Inc.

7606 Bridgeport Road
Portland, Oregon 97224

Phone: 971-249-1600

Fax: 971-249-1601

Web Site: www.evanscomponents.com

NOTE: Product availability and specifications contained herein are subject to change without notice. Consult local distributor or factory for potential revisions.

06/08